

**AERODROME LICENCE**

**ORDINARY**

**BLACKBUSHE**

**CIVIL AVIATION AUTHORITY**

**AERODROME LICENCE**

**ORDINARY**

**BLACKBUSHE**



**LICENCE NO. P693**

**DATE OF ISSUE 16 JANUARY 2015**

<b>Licence No. <u>P693</u></b>		
<b>1</b>	<b>Name of Aerodrome</b>	<b>BLACKBUSHE</b>
<b>2</b>	<b>Position of Aerodrome</b>	<b>3 MILES WEST OF CAMBERLEY (see map in Schedule 1)</b>
<b>3</b>	<b>Name and Address of Licence Holder</b>	<b>BLACKBUSHE AIRPORT LTD BLACKBUSHE AIRPORT CAMBERLEY SURREY GU17 9LQ</b>

The Civil Aviation Authority (in this licence referred to as 'the CAA') in exercise of its powers under Article 211 of the Air Navigation Order hereby licenses the above-named aerodrome as an aerodrome to be used as a place of take-off and landing of aircraft engaged in flights for the purpose of the public transport of passengers or for the purpose of instruction in flying, subject to the following conditions:

- 1 The aerodrome is licensed for use only by the licence holder and by persons specifically authorised by him.
- 2 No aircraft shall take-off or land at the aerodrome unless such fire-fighting and rescue services and such medical services and equipment as are required in respect of such an aircraft in the CAA's publication CAP 168 (Licensing of Aerodromes) are provided there. Such services and equipment shall at all times when the aerodrome is available for the take-off or landing of aircraft be kept fit and ready for immediate turnout.
- 3 Changes in the physical characteristics of the aerodrome including the erection of new buildings and alterations to existing buildings or to visual aids shall not be made without prior approval of the CAA.
- 4 The licence holder shall, by the quickest means available, notify the CAA of any material change in the surface of the landing area, or in the obstruction characteristics of the approach, take-off or circuit in relation to the aerodrome.
- 5 The aerodrome is licensed for the take-off and landing of aircraft at night. Such systems of lighting appropriate to the Category of runway in use as described in the CAA's publication CAP 168 (Licensing of Aerodromes), shall be in operation at all times when aircraft are taking-off or landing at the aerodrome at night, provided that minor temporary unserviceability, not of a character likely to affect the safety of operations, shall not preclude the take-off or landing of aircraft.
- 6 Any public right of way crossing or bordering the landing area shall be adequately sign-posted with notices warning the public of danger from aircraft.
- 7 Expressions used in this licence shall have the same respective meanings as in the Air Navigation Order.
- 8 The 'Air Navigation Order' in this licence means the Air Navigation Order 2009 and any reference to the Order or to any Article of the Order shall, if that Order be amended or replaced, be taken to be a reference to the Air Navigation Order for the time being in force or the corresponding Article of that Order.

This licence shall remain in force until it is varied, suspended or revoked.

Date: 16 January 2015



**FOR THE CIVIL AVIATION AUTHORITY**

**SCHEDULE 1 - REPRODUCTION OF PORTION OF ORDNANCE SURVEY MAP,  
SHOWING EXACT POSITION OF AERODROME.**

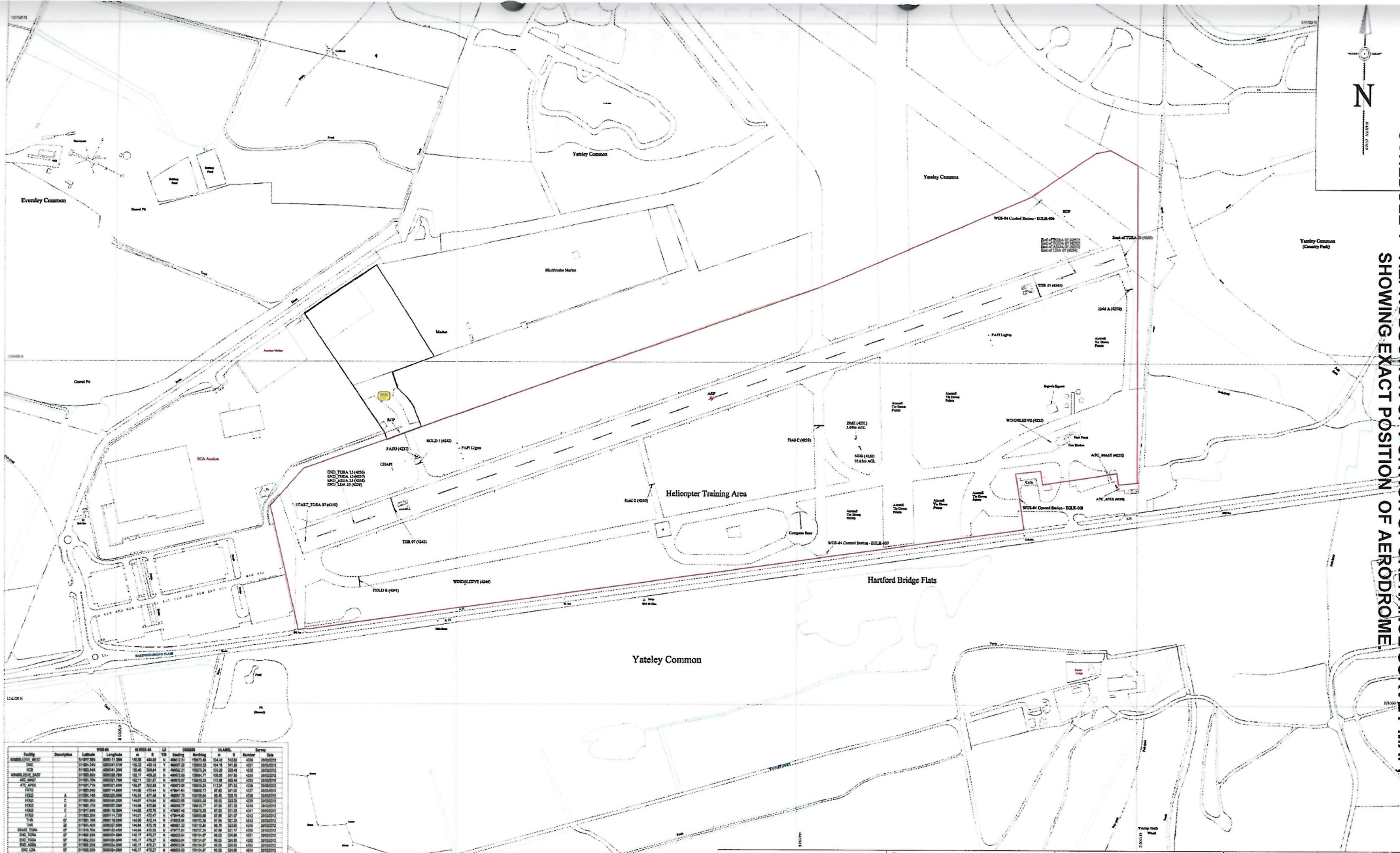

Feature	Description	WGS-84	OSGB-36	OSGB-36	OSGB-36	OSGB-36	OSGB-36	OSGB-36	OSGB-36	OSGB-36	OSGB-36	OSGB-36
AVIA	AVIATION	51 497 100	51 497 100	51 497 100	51 497 100	51 497 100	51 497 100	51 497 100	51 497 100	51 497 100	51 497 100	51 497 100

Field	Value	Field	Value	Field	Value	Field	Value	Field	Value
1	AVIA	2	AVIA	3	AVIA	4	AVIA	5	AVIA

Assignment	By	Date
A	AVIA	08/11/12

**SLC ASSOCIATES**  
Aviation Support Division

Broadfields Court  
Blosser Road  
Aylesbury  
Bucks HP19 8BU

e-mail: info@slcassociates.co.uk  
Tel: +44 (0) 1296 717 500



**Blackbushe Airport Limited**  
Terminal Buildings  
Camberley  
Surrey  
GU17 9LQ

Drawing Title: **Aerodrome Plan**

Dwgs: GEC, Checked: GDB, Issue: 1:2,500

Levelled: All levels are in metres and refer to Mean Sea Level (Ordnance Datum - Newlyn)

Conditions: All annotations are in position and refer to National Grid (OSGB36)

Drawn Number: CA-12-195-01

Date of Survey: **February 2012**

Date of Issue: **April 2012**

Surveyed by: **Peter James**

Drawn by: **Peter James**

# CIVIL AVIATION AUTHORITY

AIR NAVIGATION ORDER 2009

AERODROME LICENCE NO.: P693

## PERMISSION

1. The CAA hereby permits pursuant to Article 218 (1) of the Air Navigation Order 2009 Blackbushe Airport Ltd to establish and maintain at BLACKBUSHE Aerodrome those aeronautical ground lights specified below.

	Runway		Runway		Comments
	07	25			
<b>APPROACH</b>					
HI Coded Centreline					
Supplementary					
HI C/L Bar Simple					
Sequenced strobe					
<b>APPROACH SLOPE</b>					
PAPI	X	X			
HI APAPI					
LI APAPI					
<b>RUNWAY</b>					
HI edge, threshold, end	X	X			
LI edge, threshold, end					
HI Centreline					
Touchdown zone					
Stopway					
<b>OTHER</b>					
CHAPI					5.0 degree, Proportional T

<b>TAXIWAY</b>	
Centreline	
Edge	X
Illuminated signs	X
Stop bars	
Runway guards	X

<b>OBSTACLE</b>	X

<b>AERODROME BEACON</b>	
Identification	
Location	X

2. This Permission shall remain in force until revoked.

DATE 16/1/15 .....

SIGNED *Graeme Mitchell*  
For and on behalf of the Civil Aviation Authority